

Technical data sheet



Product features

Cooking range electric 2x plate on open cabinet 400 V

Model	SAP Code	00012306
SPL 90/40 E	A group of articles - web	Stoves



- Device type: Electric unit
- Power consumption of the zone 1 [kW]: 2,5
- Power consumption of the zone 2 [kW]: 2,5
- Material: AISI 304 top plate, AISI 430 cladding

SAP Code	00012306	Power electric [kW]	5.000
Net Width [mm]	400	Loading	400 V / 3N - 50 Hz
Net Depth [mm]	900	Number of zones	2
Net Height [mm]	900	Power consumption of the zone 1 [kW]	2,5
Net Weight [kg]	62.00	Power consumption of the zone 2 [kW]	2,5

Technical data sheet



Technical drawing

Cooking range electric 2x plate on open cabinet 400 V

Model	SAP Code	00012306
SPL 90/40 E	A group of articles - web	Stoves

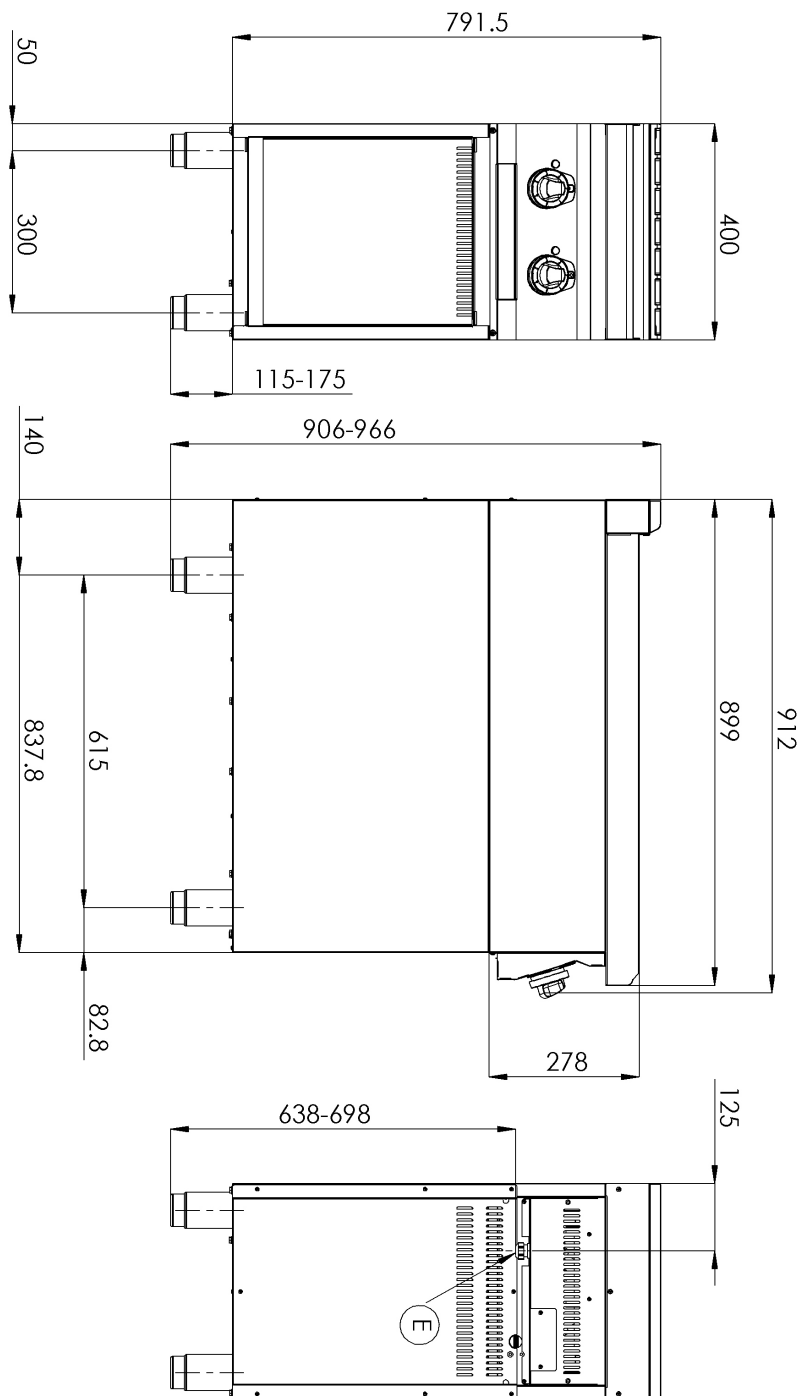

Cooking range electric 2x plate on open cabinet 400 V

Model	SAP Code	00012306
SPL 90/40 E	A group of articles - web	Stoves

1

Square plates

- quick warm-up
efficient cooking on a round surface with easy adhesion to dishes
- time-saving in food preparation
 - easy to use thanks to the large surface area of the cooking plates

2

Internal thermostatic plate protection

- longer service life of the plates
- no overheating of the plates and no cracking

3

Degree of protection of the control elements IPX4

- maintenance-free system
resistance to splash water
long life
- savings on service interventions
 - easy cleaning and maintenance of equipment

4

All-stainless design

- long life
resistance of a ground steel plate with a thickness of 10 mm
- savings on service interventions
 - higher corrosion resistance

5

Hygienic moldings of the top plate

- absence of sharp corners and edges (potential places where dirt could stick)
smooth transitions
- easy quick cleaning

6

Variability

- the possibility of adding to the current line
easy possibility of creating one module
long life
- cost saving
 - space saving
 - long service life

Technical data sheet



Technical parameters

Cooking range electric 2x plate on open cabinet 400 V

Model	SAP Code	00012306
SPL 90/40 E	A group of articles - web	Stoves

1. SAP Code:

00012306

2. Net Width [mm]:

400

3. Net Depth [mm]:

900

4. Net Height [mm]:

900

5. Net Weight [kg]:

62.00

6. Gross Width [mm]:

440

7. Gross depth [mm]:

970

8. Gross Height [mm]:

1160

9. Gross Weight [kg]:

70.00

10. Device type:

Electric unit

11. Construction type of device:

With substructure

12. Power electric [kW]:

5.000

13. Loading:

400 V / 3N - 50 Hz

14. Material:

AISI 304 top plate, AISI 430 cladding

15. Worktop material:

AISI 304

16. Worktop Thickness [mm]:

1.50

17. Number of zones:

2

18. Power consumption of the zone 1 [kW]:

2,5

19. Power consumption of the zone 2 [kW]:

2,5

20. Number of power control stages:

7

21. Adjustable feet:

Yes

22. Number of burners/hot plates:

2

23. Type of electric cooking zones:

Squared

24. Cross-section of conductors CU [mm²]:

1